



# Quick Installation Guide

X1 Series 0.7KW-2.0KW

II

## Inverter Installation



- Unscrew the bracket from the back of the inverter.
- Mark the position of the two holes.

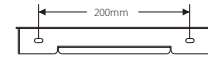
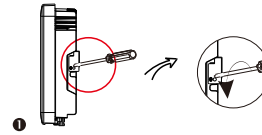

- Drill holes with  $\phi 10$ .
- Depth: at least 50mm.

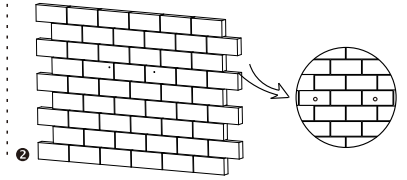

- Tighten the expansion tubes.

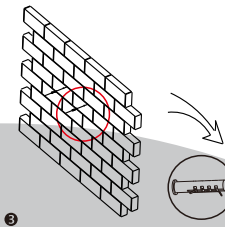

- Screw the expansion screws.

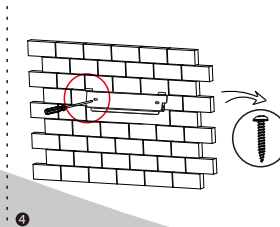

- Match the inverter with the bracket.
- Screw the cross recessed screw on the right side.

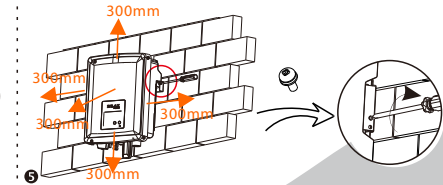

I

## Packing Lists

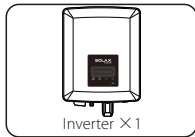

Inverter X1

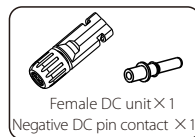

Female DC unit X1  
Negative DC pin contact X1

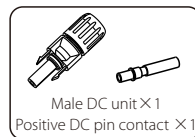

Male DC unit X1  
Positive DC pin contact X1

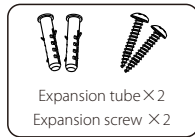

Expansion tube X2  
Expansion screw X2



Ring terminal X1



AC terminal X1

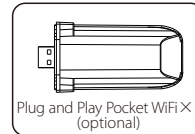

Plug and Play Pocket WiFi X1  
(optional)



Product manual X1



Quick installation guide X1

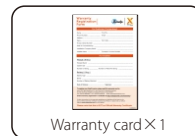

Warranty card X1

Note:

1) Please refer to the appropriate instruction manual for the usage of optional accessories.

III

## PV Connection



Cable size: 12 AWG  
strip length:

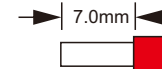

-Align the two halves connectors.

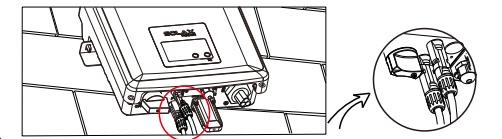

positive DC  
pin contact

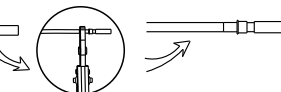

male plug

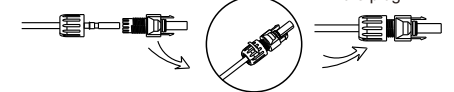

negative DC  
pin contact

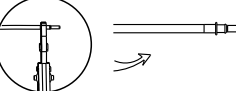

nut

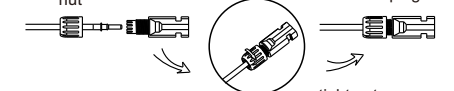

female plug

tight nut

clamp contact

# IV

## AC Connection

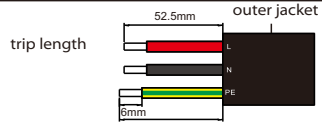

Model	X1-0.7/1.1/1.5-S-N/D (L)	X1-2.0-S-N/D (L)
L,N cable	2.5-6mm <sup>2</sup>	2.5-6mm <sup>2</sup>
PE cable	2.5-6mm <sup>2</sup>	2.5-6mm <sup>2</sup>
Micro-breaker	10A	16A

1. Slide the cable nut and back shell onto the cable.

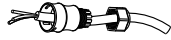

2. Insert the tripped end of each three wires into holes in the female insert, then tighten each screw with L-type wrench.



3. Screw down the threaded sleeve of the pressure screw.



4. Screw down the pressure screw.



5. Connect the AC plug to the inverter, and screw down the pressure screw on the top part of AC terminal.

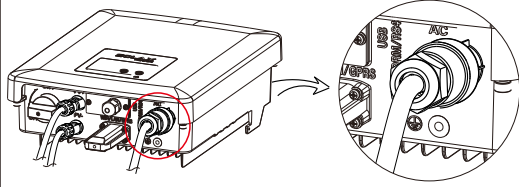

## Firmware Upgrading

- Open the communication lid on the bottom of the inverter as below.

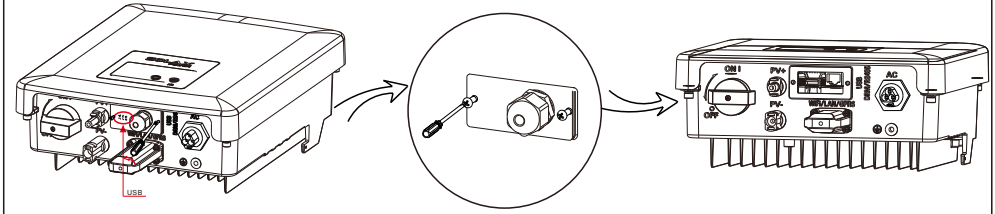

- Download the upgrade program into USB flash drive.

- Insert the USB flash drive with program into the "USB" port on the bottom.

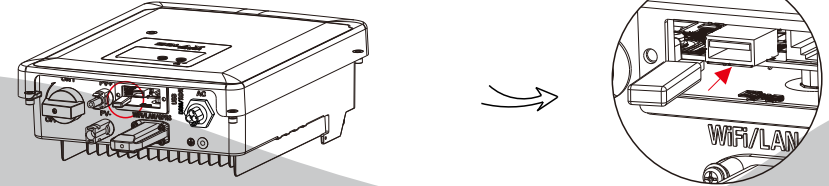

# V

## Connections and Overview

- Screw the ground screw with  $\Phi 4$  hexagon wrench shown as follow.

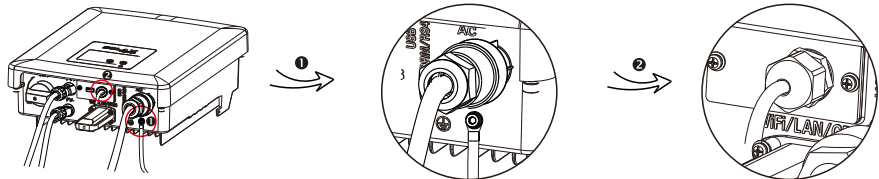

- Prepare the connector and the communication cable, following the PIN definition and assembly order below, then insert the cable into the corresponding 485 port of the inverter, and tighten the waterproof connector.

1	PIN	1	2	3	4	5	6	7	8
8	Definition	RefGen	Com/DRM0	GND_COM	METER_A/ 485_A	METER_B/ 485_B	E_Stop	GND_COM	X

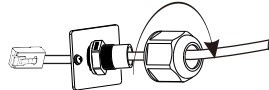

- Overview for connection.

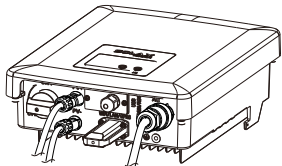

- After checking all connections are correct, turn on the external DC /AC breakers.

- Turn on the DC switch to the "ON" position.

- Inverter will start automatically when PV panels generate enough energy. The LED will be blue and the LCD screen will display the main interface.

## Firmware Upgrading

➤ For the inverter with LCD, user can refer to the following:

- Please contact Solax service to get the latest firmware. Then add a new folder named "Update" in the root directory on your U-disk, and two more sub-folders named "ARM" and "DSP" under "Update". Please copy the firmware files into ARM and DSP respectively. It will be like:  
 update\ARM\618.00207.00\_X1\_BOOST3.0\_MINI2.0\_AIR2.0\_ARM\_V1.10\_20190828.usb;  
 "update\DSP\618.00205.00\_X1\_BOOST3.0\_MINI2.0\_AIR2.0\_DSP\_V1.09\_20190613.usb  
 Press and hold the "Enter" key for 5 seconds to enter Off Mode. Then unscrew the waterproof lid and insert the U-disk into the "upgrade" port.

- When the user turns on all the switches, the LCD will show pictures as below. And at the same time, the user can choose the program you need by short pressing " " and "V" key, and then long press "V" to confirm and upgrade the inverter.

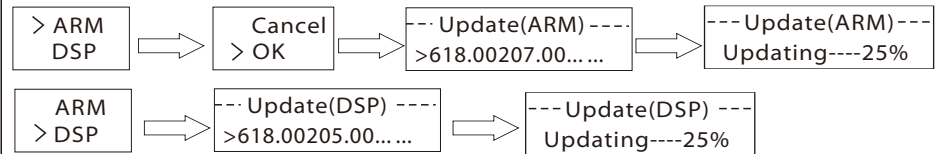

- After the upgrade is complete, please pull off the USB flash drive, and then screw the panel of USB port.

\* Please contact our service support to get the update package, and extract it into your USB flash drive. Please **DO NOT** modify the program file name! Otherwise it may cause the inverter not work anymore!